



Smart Post-top G3

BGP161 LED2500/NW PSU 220-240V 7043 IN

Smart Post Top G3 inherits the classic look and style of the previous generation with improved system efficacy and light quality.;The Smart Post Top G3 optimized optical design increases both horizontal and vertical uniformity. The highly efficient thermal system design ensures maximum heat transfer and longer LED service life.;This reliable luminaire system operates well in both low and high temperature environments. It offers more than 11 years expected life, reducing maintenance frequency and cost (based on a 50,000 hour rated life and 12 hours operation per day);It provides a comfortable and safe atmosphere to gardens, residential areas, courtyards, side streets, squares, parks & playgrounds.

Product data

General Information		ENEC mark	
Lamp family code	-	Warranty period	3 years
Light source color	Neutral white	Optic type outdoor	Symmetrical
Light source replaceable	Yes	Constant light output	No
Number of gear units	1 unit	Number of products on MCB of 16 A type B	-
Driver/power unit/transformer	Power supply unit	RoHS mark	RoHS mark
Driver included	Yes	Light source engine type	LED
Optical cover/lens type	Acrylate cover and semi-matt high-reflective optic	Light Technical	
Luminaire light beam spread	-	Upward light output ratio	0
Control interface	-	Standard tilt angle posttop	-
Connection	Flying leads/wires	Standard tilt angle side entry	-
Cable	Cable 0.45 m without plug	Operating and Electrical	
Protection class IEC	Safety class I	Input Voltage	220 to 240 V
Flammability mark	-	Input Frequency	50 to 60 Hz
CE mark	-		

Smart Post-top G3

Inrush current	2.1 A
Inrush time	22.3 ms
Power Factor (Min)	0.9

Controls and Dimming

Dimmable	No
----------	----

Mechanical and Housing

Housing Material	Aluminum die cast
Reflector material	Acrylate
Optic material	Acrylate
Optical cover/lens material	Acrylate
Fixation material	Stainless steel
Mounting device	Post-top for diameter 60 mm
Optical cover/lens shape	Flat
Optical cover/lens finish	Frosted
Overall height	265 mm
Overall diameter	578 mm
Color	Dark gray

Approval and Application

Ingress protection code	IP65 [Dust penetration-protected, jet-proof]
Mech. impact protection code	IK07 [2 J reinforced]
Surge Protection (Common/Differential)	4/2 kV

Initial Performance (IEC Compliant)

Initial luminous flux (system flux)	2500 lm
Luminous flux tolerance	+/-10%
Initial LED luminaire efficacy	86.20689655172414 lm/W
Init. Corr. Color Temperature	4000 K
Init. Color Rendering Index	70
Initial chromaticity	SDCM>5
Initial input power	29 W
Power consumption tolerance	+/-10%

Application Conditions

Ambient temperature range	-40 to +50 °C
Maximum dim level	Not applicable

Product Data

Full product code	911401633703
Order product name	BGP161 LED2500/NW PSU 220-240V 7043 IN
Order code	911401633703
Numerator - Quantity Per Pack	1
Numerator - Packs per outer box	2
Material Nr. (12NC)	911401633703
Net Weight (Piece)	4.499 kg

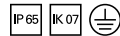

Dimensional drawing

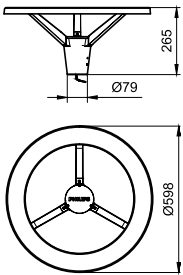

Smart Post-top G3

Smart Post-top G3

